

CORPORATE W20

scala 1/1

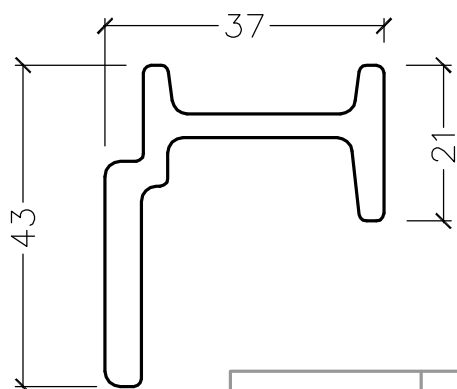

W8-630 2.80 kg/ml

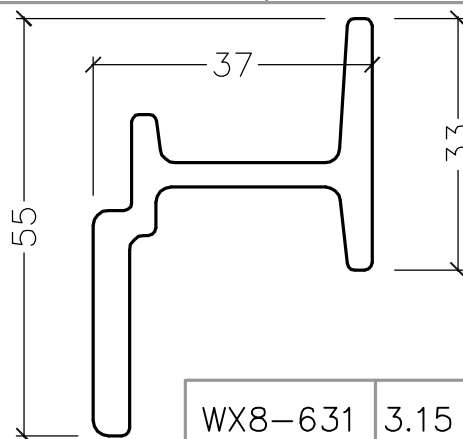

WX8-631 3.15 kg/ml

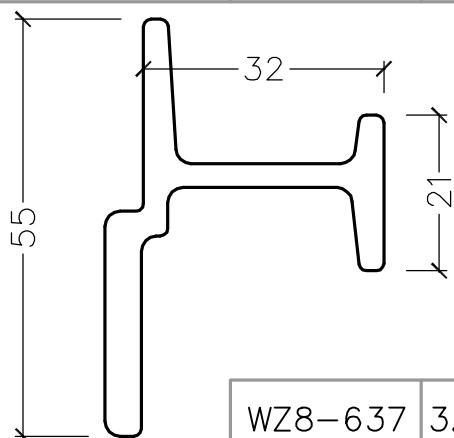

WZ8-637 3.18 kg/ml

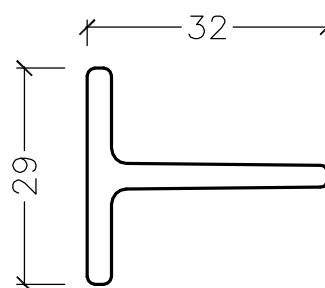

WT2-644 1.40 kg/ml

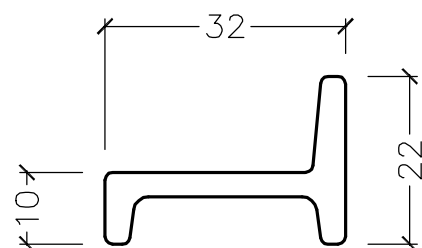

W7-640 1.53 kg/ml

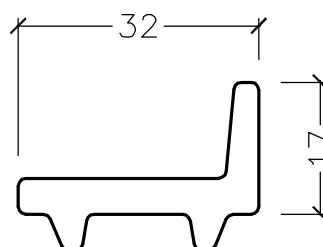

W2-627 1.84 kg/ml

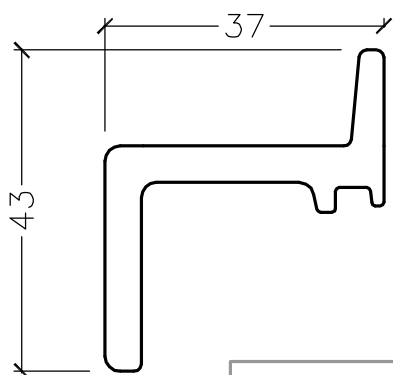

WH6-629 2.86 kg/ml

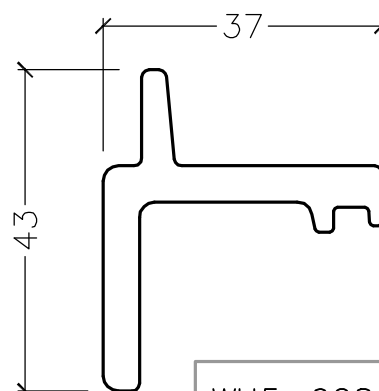

WH5-628 2.90 kg/ml

